

\*\*COUNTER FLASHING (BY OTHERS)\*\*

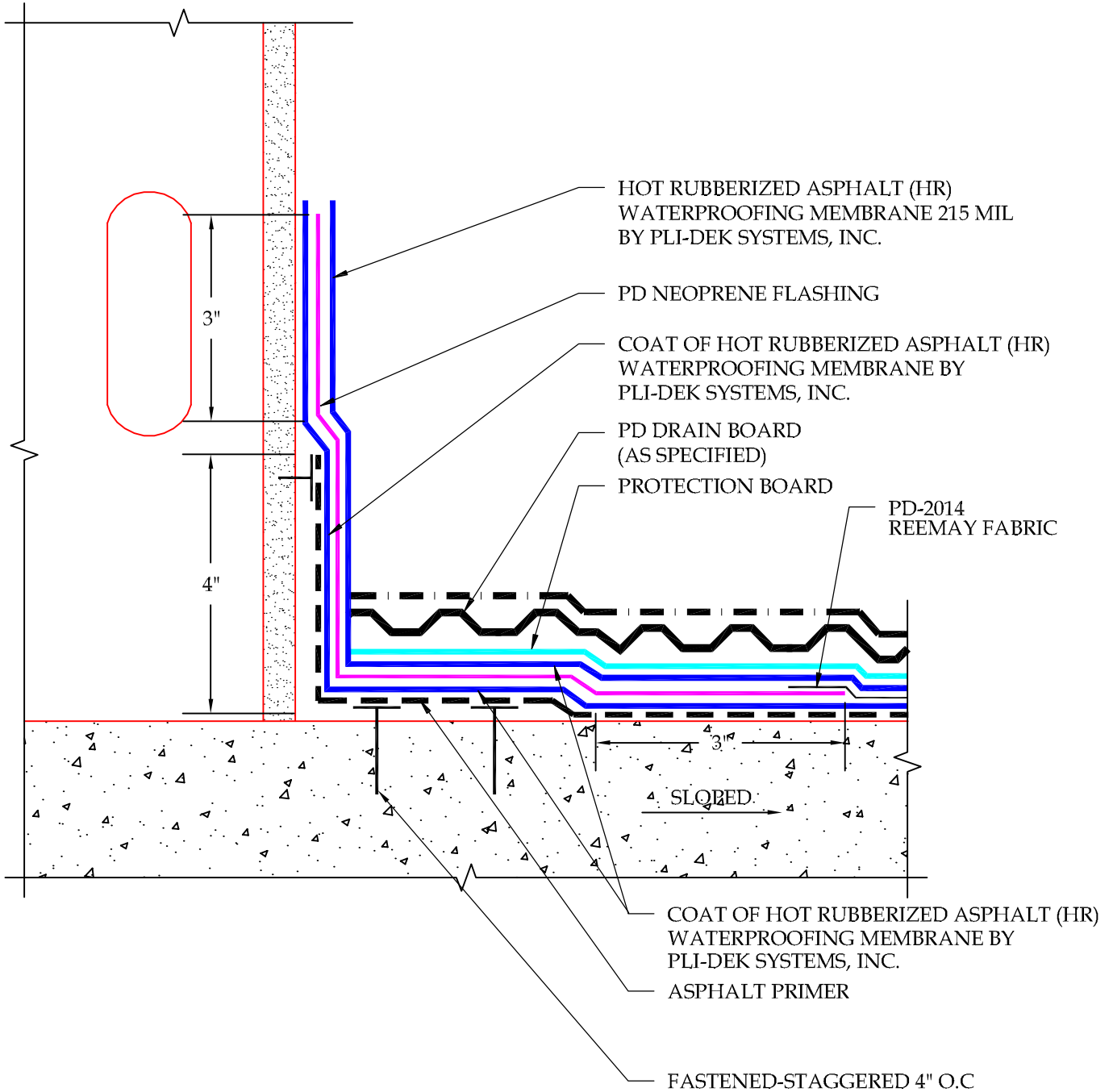

NOTE:  
SLOPE CONCRETE 1/8"  
PER 12"

DETAIL-CORNER DETAIL FRAME CONSTRUCTION  
NEOPRENE FLASHING

SCALE: N.T.S.



41610 Date St., Suite 104 \* Murrieta, CA. 92562  
Phone: 800.364.0287 \* Fax: 951.834.9555  
WWW.PLIIDEK.COM

These waterproofing procedures are not to be used for permit and should be reviewed by the project architect. The waterproofing procedures are not complete plans or specifications and a professional design professional should be contacted prior to performing major waterproofing and repairs.

System:		Hot Rubberized Asphalt (HR) by Pli-Dek Systems, Inc.	
Detail:		Corner Detail Frame Construction Neoprene Flashing	
Job:		Drawing Number:	
Date:	05-3-2013	HR-2B	
Dwn:	H.K		