

NOTE:
 DRAIN DECK PLATES MEASURES:
 230MM (9") SQUARE FOR 50MM (2")
 250MM (10") SQUARE FOR 76MM
 (3") DRAIN.

1. PLYWOOD DECK (SLOPED)
2. GALVANIZED, BONDERIZED DRAIN DECK PLATE
3. DRAIN-STRAINER
4. GU80 BASE COAT
5. 2.5 METAL LATH
6. 3/4 OZ. FIBERGLASS & PD RESIN (CONTACT PLI-DEK FOR REQUIREMENTS)
7. GU80 TOP COAT & GS88 PIGMENTED SEALER

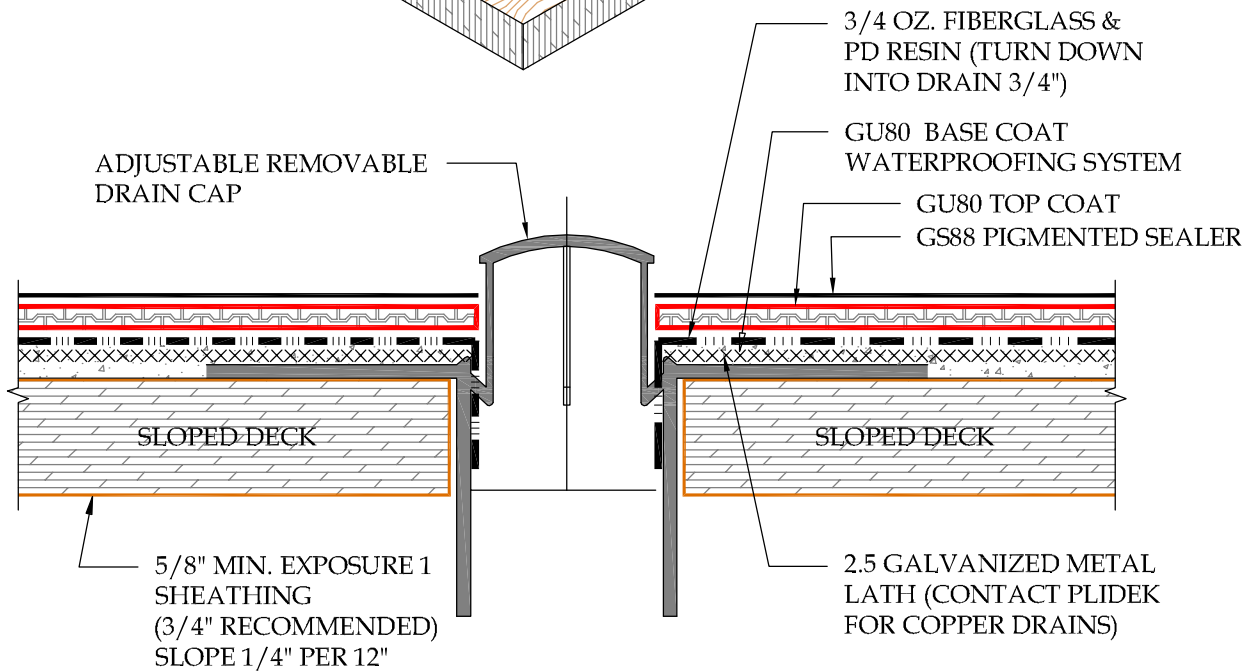
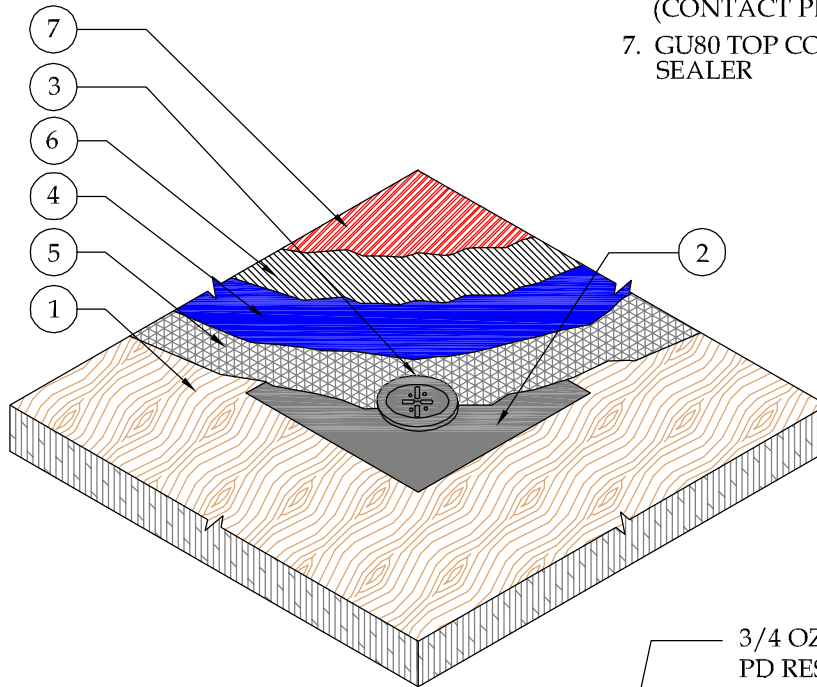

DETAIL-GALVANIZED DECK DRAIN

SCALE: N.T.S.



41610 Date St., Suite 104 * Murrieta, CA. 92562
 Phone: 800.364.0287 * Fax: 951.834.9555
 WWW.PLIIDEK.COM

These waterproofing procedures are not to be used for permit and should be reviewed by the project architect. The waterproofing procedures are not complete plans or specifications and a professional design professional should be contacted prior to performing major waterproofing and repairs.

System: Pli-Dek System
 ICC-ES ESR-2097
 Detail: GALVANIZED DECK DRAIN

Job: _____
 Date: 05-3-2013
 Dwn: H.K

Drawing Number:
PD-24