

NOTE:

- ALL FLASHING SEAMS SHOULD BE INSTALLED AS TO NOT "BUCK WATER".
- SEAL ALL SEAMS, NOTCHES, AND OVERLAPS.
- EMBED SEALANT BETWEEN OVERLAP SEAMS AND JOINTS.
- ALL FLASHING IS MINIMUM 26 GAUGE GALVANIZED (BONDERIZED).

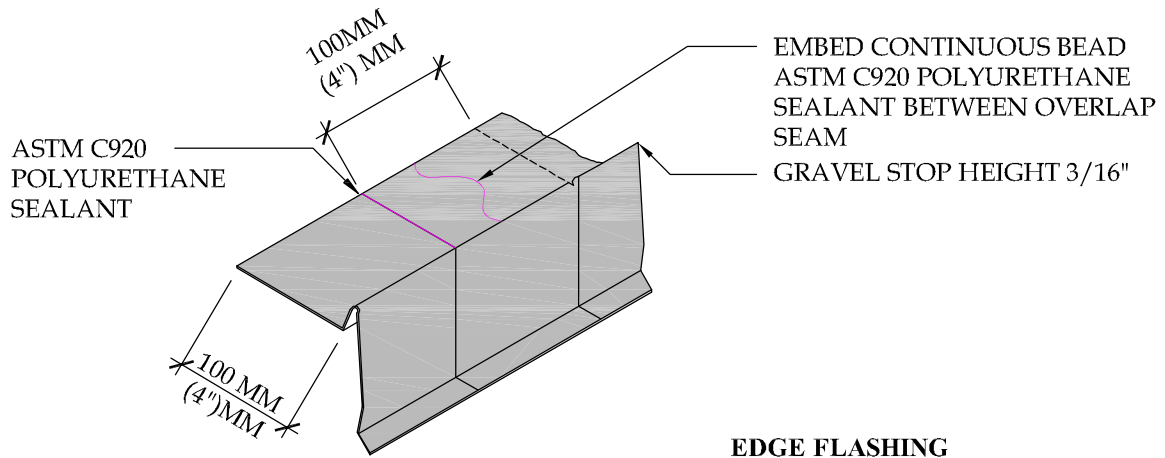

EDGE FLASHING

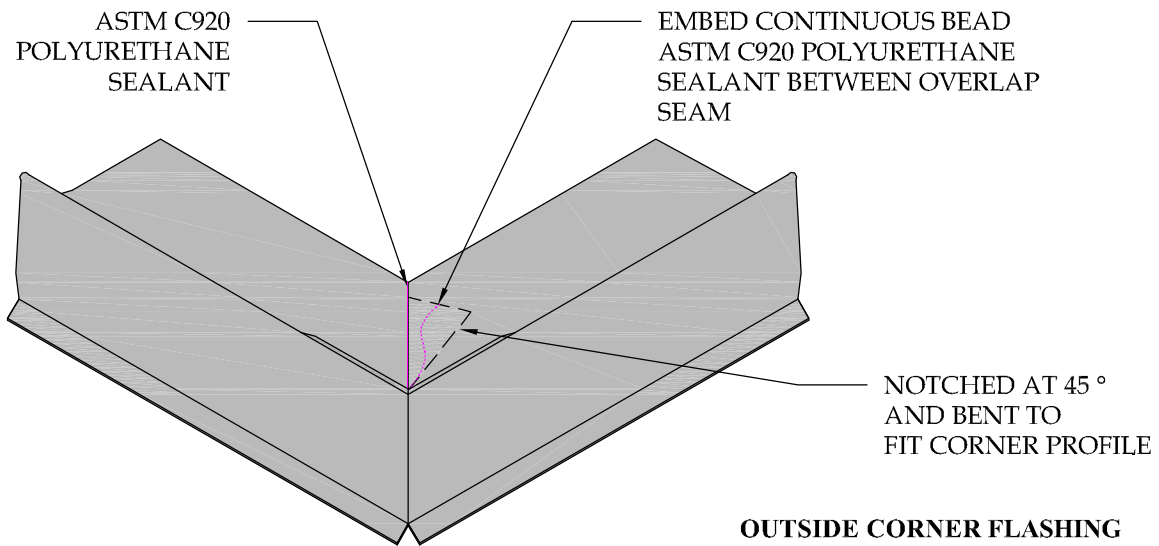

OUTSIDE CORNER FLASHING

DETAIL-PERIMETER METAL FLASHING

SCALE: N.T.S



41610 Date St., Suite 104 * Murrieta, CA. 92562
 Phone: 800.364.0287 * Fax: 951.834.9555
 WWW.PLIDEK.COM

These waterproofing procedures are not to be used for permit and should be reviewed by the project architect. The waterproofing procedures are not complete plans or specifications and a professional design professional should be contacted prior to performing major waterproofing and repairs.

System: Pli-Dek System
 ICC-ES ESR-2097
 Detail: PERIMETER METAL FLASHING

Job:
 Date: 05-3-2013
 Dwn: H.K

Drawing Number:
PD-28D