

3/4" FIBERGLASS & PD RESIN
(CONTACT PLI-DEK FOR REQUIREMENTS)

GU80 BASE COAT
GU80 TOP COAT
GS88 PIGMENTED
SEALER
ASTM C-920
POLYURETHANE
SEALANT

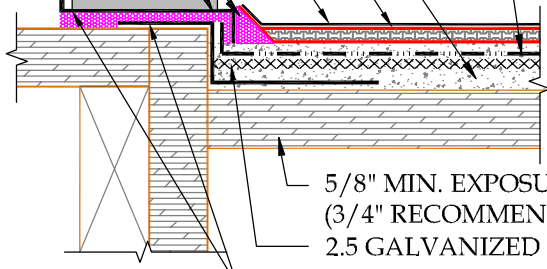

5/8" MIN. EXPOSURE 1 SHEATHING
(3/4" RECOMMENDED) SLOPE 1/4" PER 12"
2.5 GALVANIZED METAL LATH
MIN. 26 GA. GALVANIZED BONDERIZED
THRESHOLD FLASHING

1. WOOD STUD FRAMING
2. PLYWOOD DECK (SLOPED)
3. 2.5 METAL LATH
4. GU80 BASE COAT
5. MIN. 26 GA. GALVANIZED, THRESHOLD FLASHING (BONDERIZED)
6. ASTM C-920 POLYURETHANE SEALANT
7. 3/4 OZ. FIBERGLASS & PD RESIN (CONTACT PLI-DEK FOR REQUIREMENTS)
8. GU80 TOP COAT
9. GS88 PIGMENTED SEALER

DETAIL C
SCALE: N.T.S.

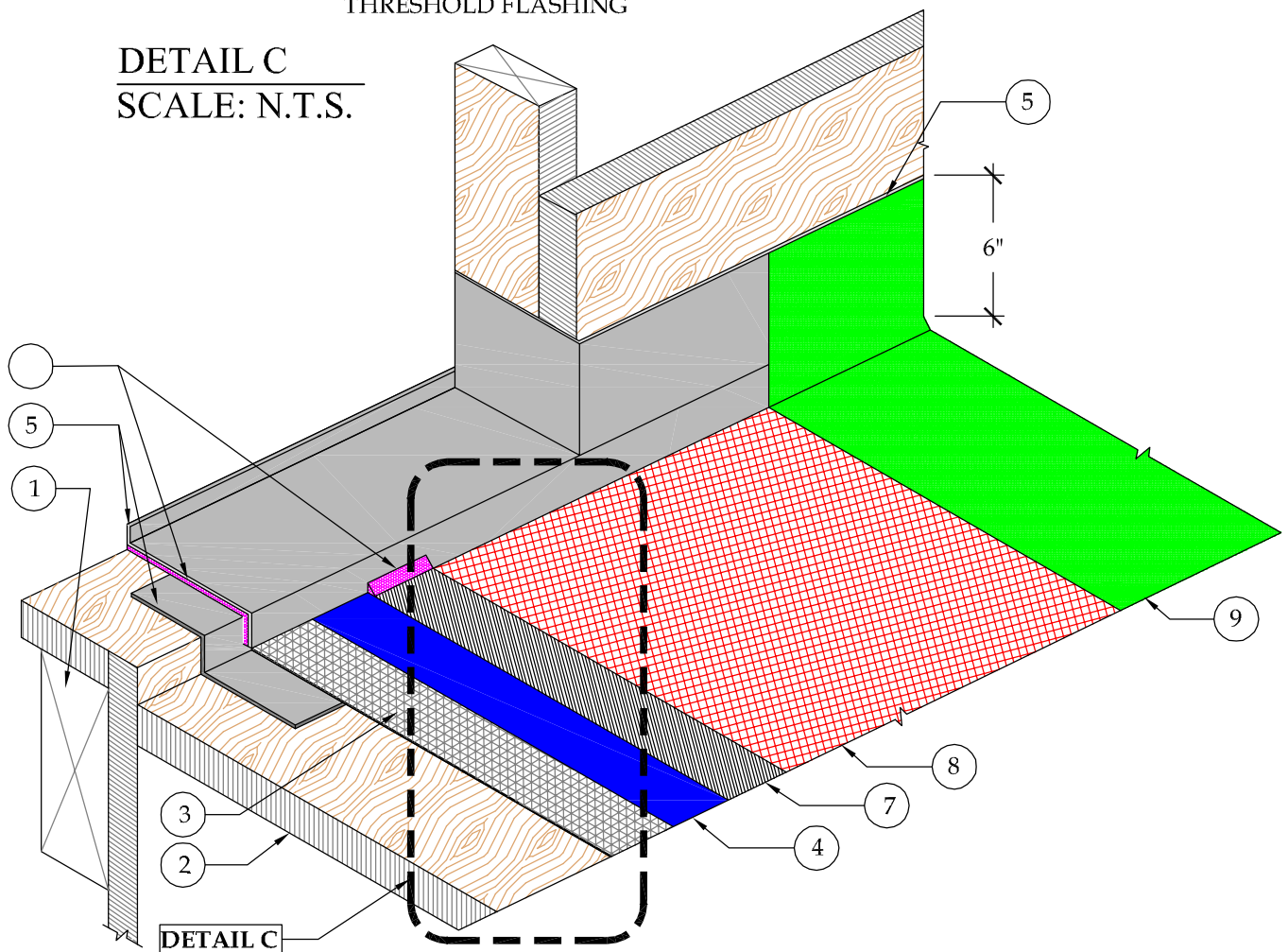

DETAIL-THRESHOLD FLASHING-TWO PIECE DOOR PAN FLASHING
1-1/2" MIN. ISOMETRIC
SCALE: N.T.S.



41610 Date St., Suite 104 * Murrieta, CA. 92562
Phone: 800.364.0287 * Fax: 951.834.9555
WWW.PLIIDEK.COM

These waterproofing procedures are not to be used for permit and should be reviewed by the project architect. The waterproofing procedures are not complete plans or specifications and a professional design professional should be contacted prior to performing major waterproofing and repairs.

System:		Pli-Dek System ICC-ES ESR-2097	
Detail:		THRESHOLD FLASHING- TWO PIECE DOOR PAN FLASHING 1 1/2" MIN.- ISOMETRIC	
Job:		Drawing Number:	
Date:	05-3-2013	PD-6	
Dwn:	H.K		