

**NOTE:**  
**DRAIN DECK PLATES MEASURES:**  
 230MM (9") SQUARE FOR 50MM (2")  
 250MM (10") SQUARE FOR 76MM (3")  
 DRAIN.

**STAINLESS STEEL FASTENERS  
 REQUIRED.**

1. PLYWOOD DECK (SLOPED)
2. COPPER DRAIN DECK PLATE
3. DRAIN-STRAINER
4. PD RESIN & FIBERGLASS
5. 2.5 METAL LATH
6. GU80 BASE COAT
7. 3/4 OZ. FIBERGLASS & PD RESIN
8. GU80 TOP COAT & GS88 PIGMENTED SEALER

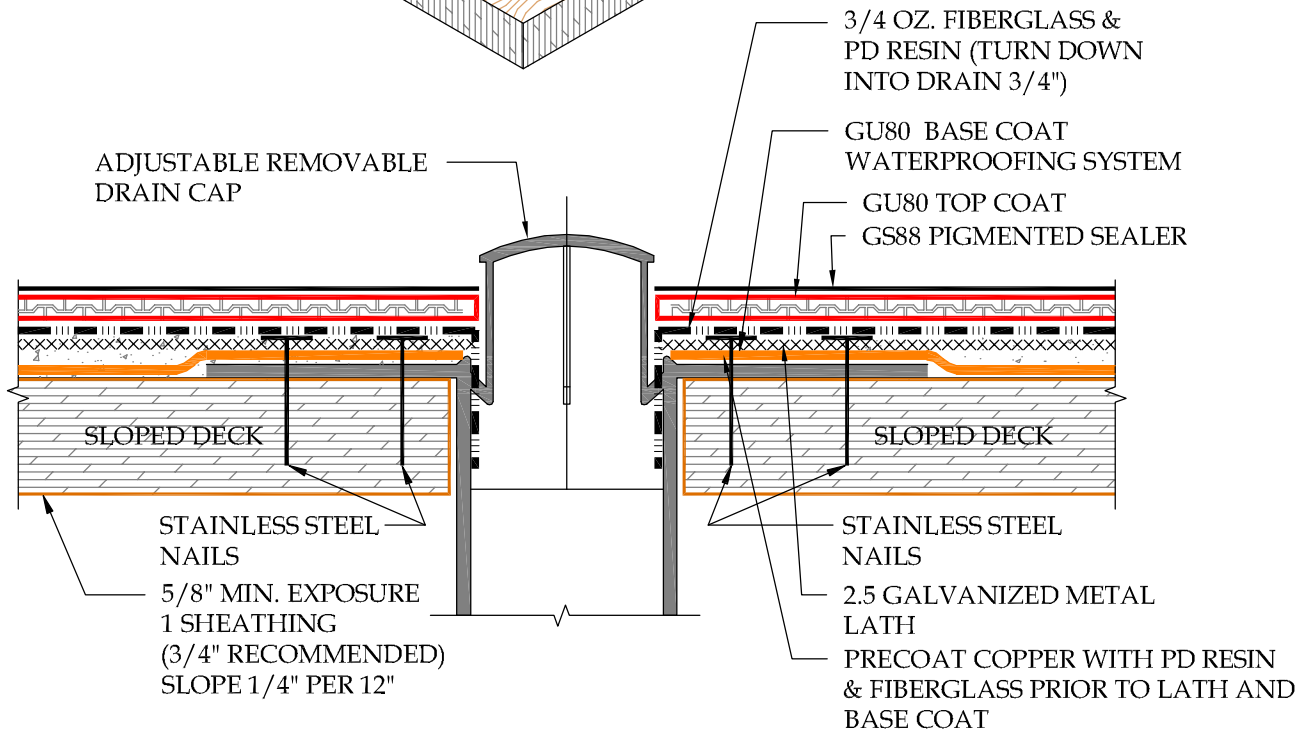
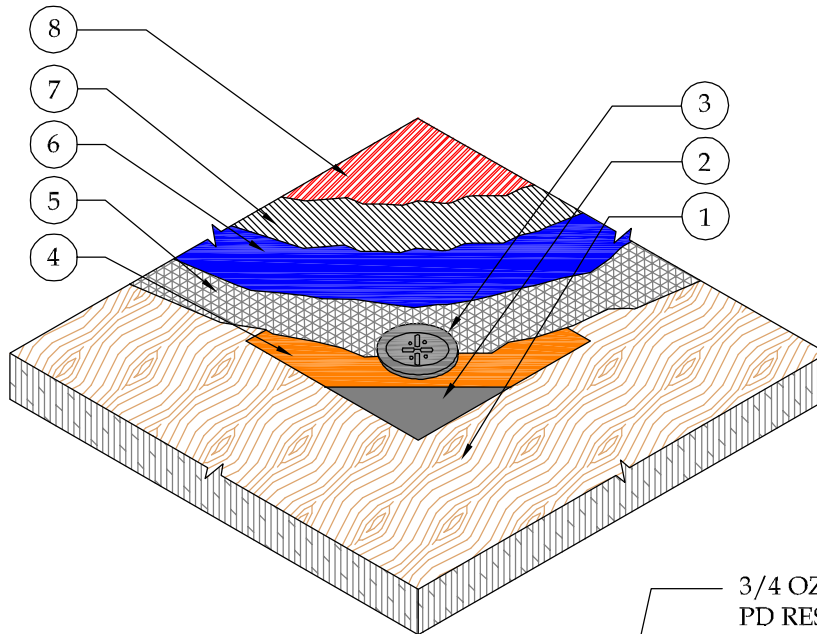

**DETAIL-COPPER DECK DRAIN**

SCALE: N.T.S.



41610 Date St., Suite 104 \* Murrieta, CA. 92562  
 Phone: 800.364.0287 \* Fax: 951.834.9555  
 WWW.PLIIDEK.COM

These waterproofing procedures are not to be used for permit and should be reviewed by the project architect. The waterproofing procedures are not complete plans or specifications and a professional design professional should be contacted prior to performing major waterproofing and repairs.

System: Pli-Dek System  
 ICC-ES ESR-2097  
 Detail: Copper Deck Drain

Job: \_\_\_\_\_  
 Date: 12-13-2013  
 Dwn: H.K

Drawing Number:  
**PD-C-2**