

1. PLYWOOD STAIR TREAD
2. PLYWOOD STAIR RISER
3. STANDARD 2" x 6", 26 GAUGE GALVANIZED, BONDERIZED FLASHING
4. 2.5 METAL LATH
5. GU80 BASE COAT
6. 3/4 OZ. FIBERGLASS & PD RESIN (CONTACT PLI-DEK FOR REQUIREMENTS)
7. GU80 TOP COAT
8. GS88 PIGMENTED SEALER

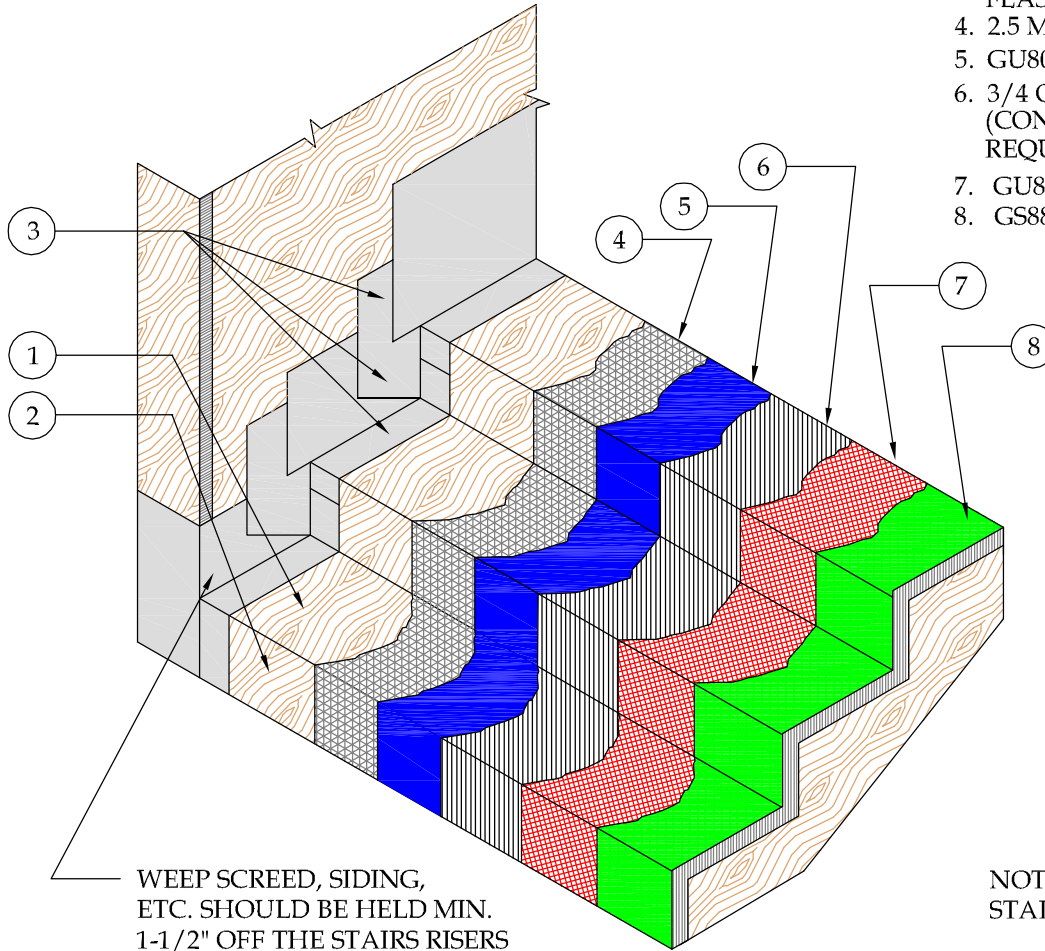

NOTE:
STAIR NOSING OPTIONAL

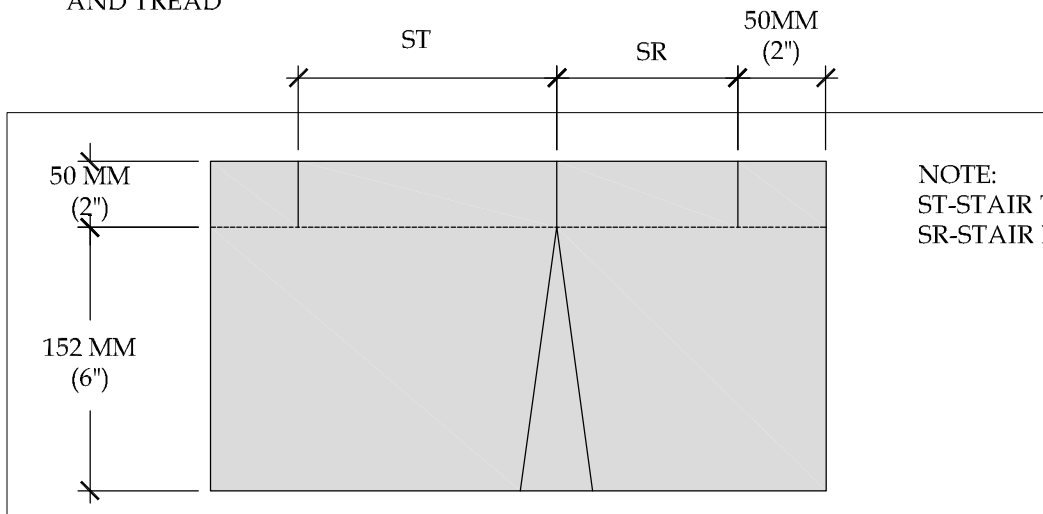

DETAIL-STAIRWAY WALL FLASHING

SCALE: N.T.S.



41610 Date St., Suite 104 * Murrieta, CA. 92562
Phone: 800.364.0287 * Fax: 951.834.9555
WWW.PLIIDEK.COM

These waterproofing procedures are not to be used for permit and should be reviewed by the project architect. The waterproofing procedures are not complete plans or specifications and a professional design professional should be contacted prior to performing major waterproofing and repairs.

System: Pli-Dek System
ICC-ES ESR-2097
Detail: Stairway Wall Flashing

Job:
Date: 05-3-2013
Dwn: H.K

Drawing Number:
PD-SA-2