

NOTE:  
 THE DESIGN, SPECIFICATIONS, AND CONSTRUCTION OF PLI-DEK PRODUCTS IS THE RESPONSIBILITY OF THE PROJECT DESIGN PROFESSIONAL. ALL SYSTEMS MUST COMPLY WITH LOCAL BUILDING CODES AND STANDARDS. THIS DETAIL IS FOR GENERAL INFORMATION AND GUIDANCE ONLY AND PLI-DEK SPECIFICALLY DISCLAIMS ANY LIABILITY FOR THE USE OF THIS DETAIL, AND FOR THE ARCHITECTURE, DESIGN, ENGINEERING OR WORKMANSHIP OF ANY PROJECT. THIS DETAIL IS SUBJECT TO CHANGE WITHOUT NOTICE. CONTACT PLI-DEK TO ENSURE YOU HAVE THE MOST RECENT VERSION. THIS DETAIL IS TO BE USED IN CONJUNCTION WITH CURRENT PLI-DEK SPECIFICATION & APPLICATION GUIDELINES.

**DETAIL A**  
 SCALE: N.T.S.

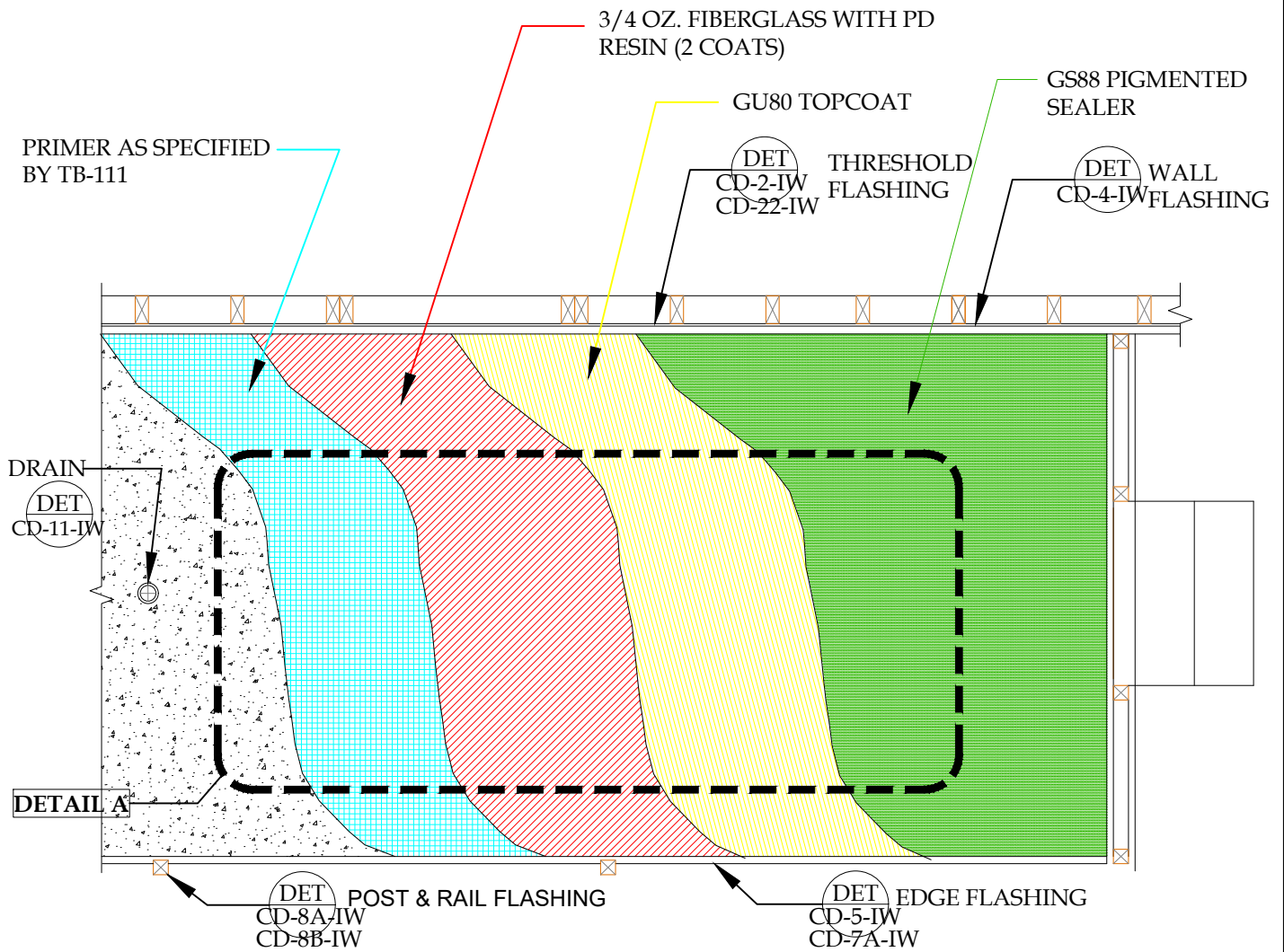

**DETAIL-DECK PLAN VIEW-INCLEMENT WEATHER**  
 SCALE: N.T.S.



**PLI-DEK**  
 WATERPROOFING SOLUTIONS  
 41610 Date St., Suite 104 \* Murrieta, CA. 92562  
 Phone: 800.364.0287 \* Fax: 951.834.9555  
 WWW.PLI-DEK.COM

These waterproofing procedures are not to be used for permit and should be reviewed by the project architect. The waterproofing procedures are not complete plans or specifications and a professional design professional should be contacted prior to performing major waterproofing and repairs.

System:	Con-Dek System by Pli-Dek Systems, Inc. ICC-ES ESR-2097	
Detail:	DECK PLAN VIEW INCLEMENT WEATHER	
Job:		Drawing Number:
Date:	04/01/2019	CD-1-IW
Dwn:	E.L.	