

NOTE:
 DRAIN DECK PLATES MEASURES:
 230MM (9") SQUARE FOR 50MM (2")
 250MM (10") SQUARE FOR 76MM
 (3") DRAIN.

1. PRIMER (AS SPECIFIED BY TB-111)
2. 3/4 OZ. FIBERGLASS & PD RESIN (2 COATS)
3. GU80 TOP COAT
4. GS88 PIGMENTED SEALER

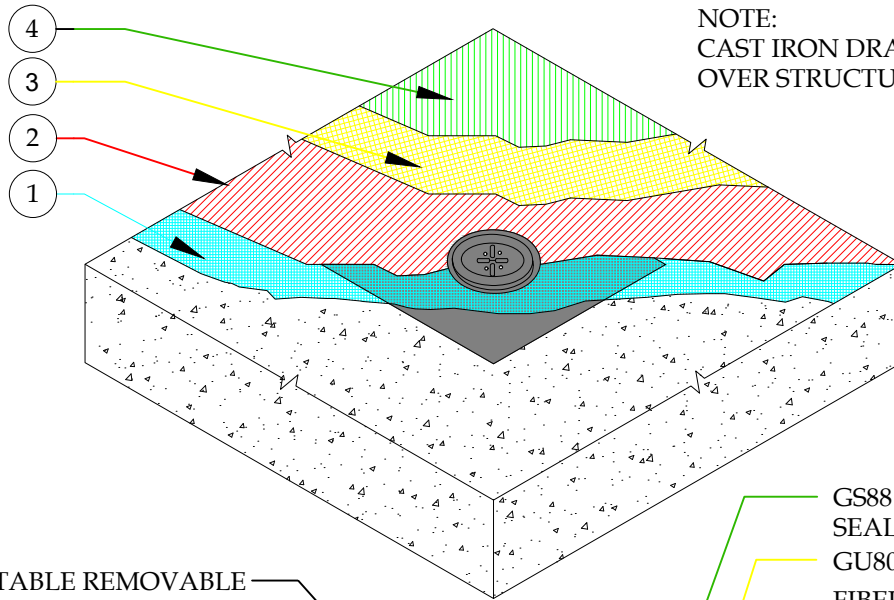

NOTE:
 CAST IRON DRAINS ARE ACCEPTABLE
 OVER STRUCTURAL CONCRETE

ADJUSTABLE REMOVABLE
 DRAIN CAP (BY OTHERS)

- GS88 PIGMENTED SEALER
- GU80 TOP COAT
- FIBERGLASS & PD RESIN (2 COATS)
- PRIMER (AS SPECIFIED BY TB-111)

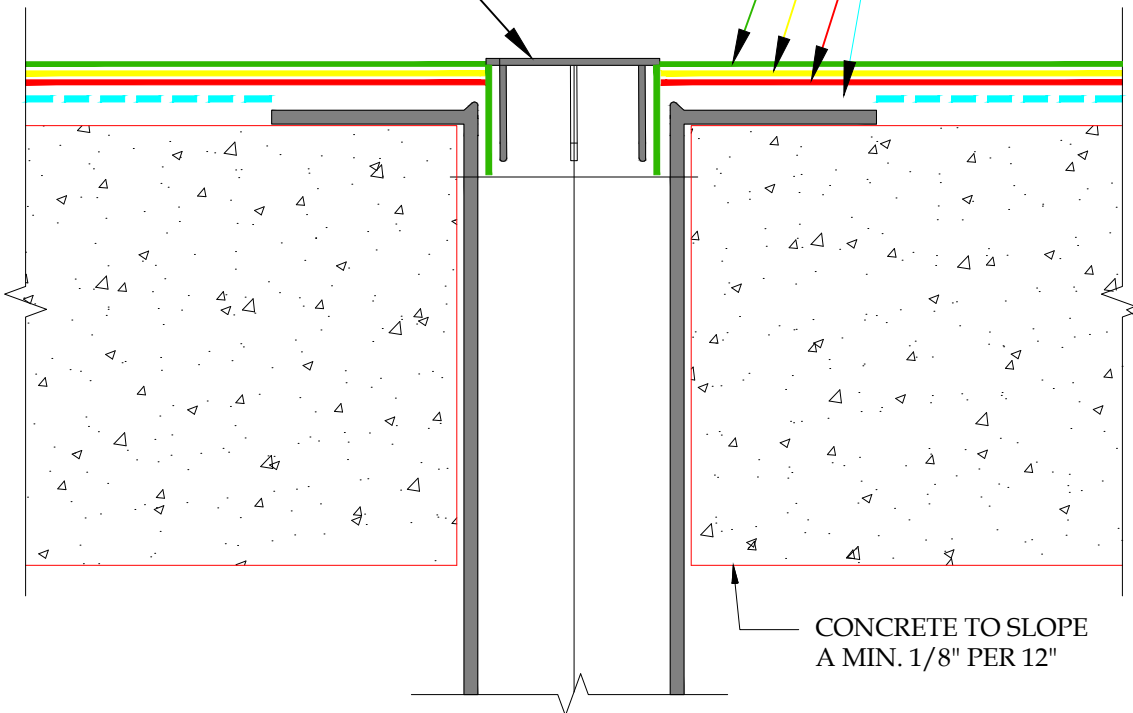

DETAIL-CONCRETE DECK DRAIN-LIGHTWEIGHT CONCRETE

SCALE: N.T.S.



PLI/DEK
 WATERPROOFING SOLUTIONS
 150 Dascomb Rd., Andover, MA 01810
 Phone: 800.364.0287 * Fax: 951.834.9555
 WWW.PLI/DEK.COM

These waterproofing procedures are not to be used for permit and should be reviewed by the project architect. The waterproofing procedures are not complete plans or specifications and a professional design professional should be contacted prior to performing major waterproofing and repairs.

System:	Con-Dek System by Pli-Dek Systems, Inc. ICC-ES ESR-2097	
Detail:	CONCRETE DECK DRAIN LIGHTWEIGHT CONCRETE	
Job:		Drawing Number:
Date:	11/01/2020	CD-11
Dwn:	E.L.	