

VERTICAL FLASHING COATED WITH PD FLASH COAT AND/OR GS88 PIGMENTED SEALER REFER TO TB-110 FOR INCLEMENT WEATHER

MIN. 26 GAUGE GALVANIZED SHEET METAL FLASHING AS SPECIFIED BY TB-110

COATING OR STUCCO FINISH (BY OTHERS)

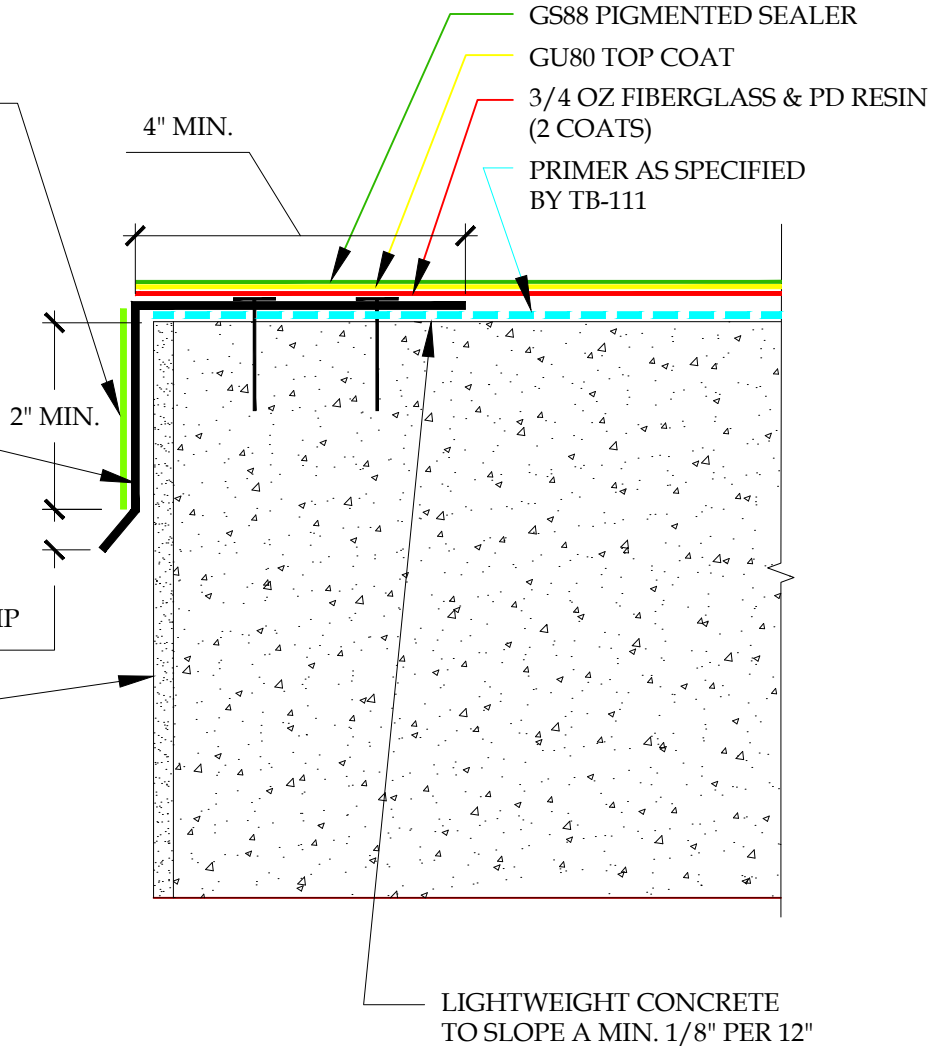

DETAIL-PERIMETER EDGE FLASHING WITH SHEET METAL DRIP-LIGHTWEIGHT CONCRETE
SCALE: N.T.S.



These waterproofing procedures are not to be used for permit and should be reviewed by the project architect. The waterproofing procedures are not complete plans or specifications and a professional design professional should be contacted prior to performing major waterproofing and repairs.

System:	Con-Dek System by Pli-Dek Systems, Inc. ICC-ES ESR-2097	
Detail:	PERIMETER EDGE FLASHING WITH METAL DRIP-LIGHTWEIGHT CONCRETE	
Job:		Drawing Number:
Date:	11/01/2020	CD-5
Dwn:	E.L.	