

5/8" MIN. EXPOSURE 1 SHEATHING  
(3/4" RECOMMENDED)  
SLOPE 1/4" PER 12"

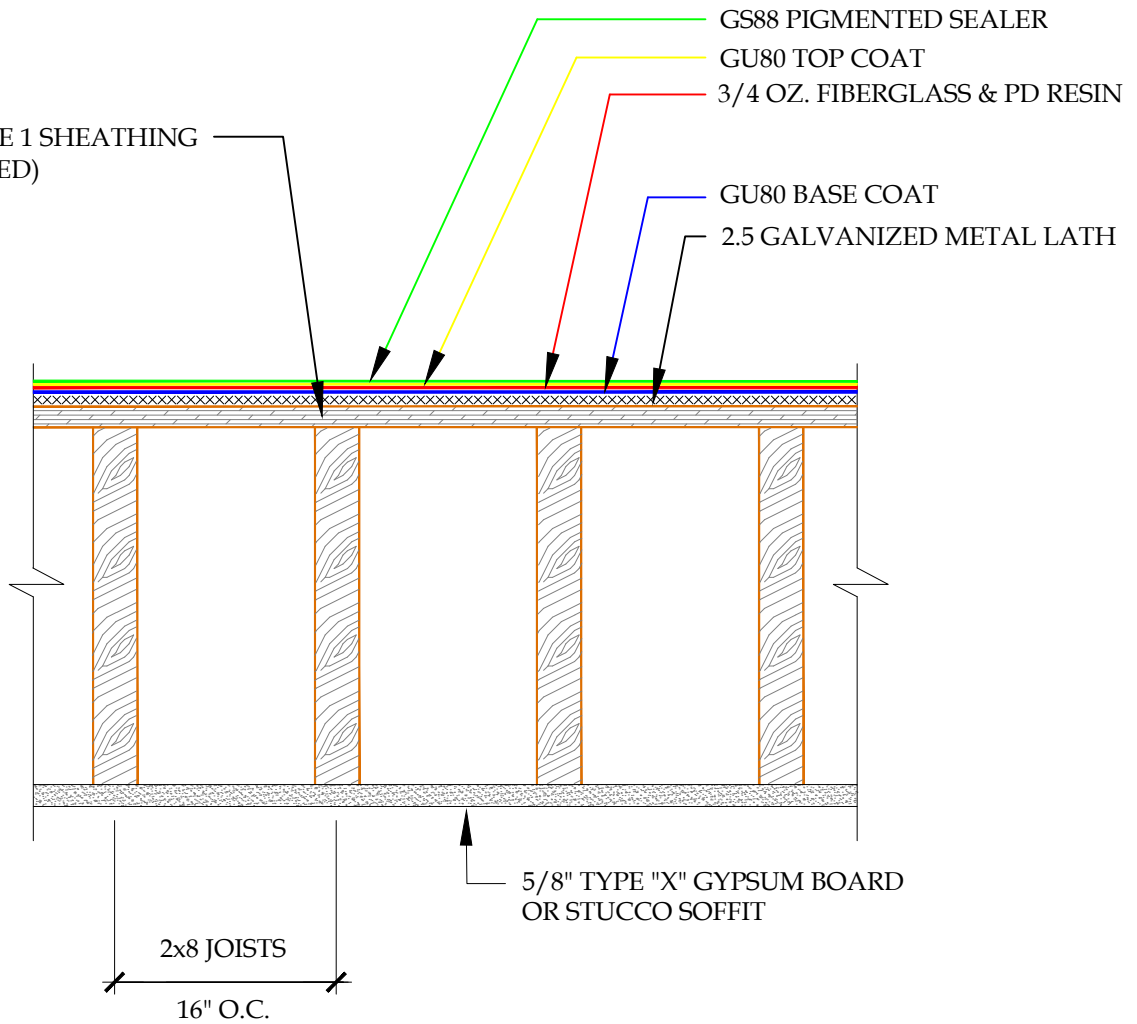

NOTE: \*PLEASE CONTACT PLI-DEK FOR ALTERNATE ONE-HOUR FIRE RATED ASSEMBLIES\*

### DETAIL-1-HR FIRE RATED ASSEMBLY

SCALE: N.T.S.



These waterproofing procedures are not to be used for permit and should be reviewed by the project architect. The waterproofing procedures are not complete plans or specifications and a professional design professional should be contacted prior to performing major waterproofing and repairs.

|         |            |                                   |  |
|---------|------------|-----------------------------------|--|
| System: |            | Pli-Dek System<br>ICC-ES ESR-2097 |  |
| Detail: |            | 1-HOUR FIRE RATED ASSEMBLY        |  |
| Job:    |            | Drawing Number:                   |  |
| Date:   | 11/01/2020 | PD-42                             |  |
| Dwn:    | E.L.       |                                   |  |