

VERTICAL FLASHING CAN BE COATED W/
 3/4OZ FIBERGLASS AND PD RESIN OR PD
 FLASH COAT AND FLASH COAT SEAM TAPE
 OR SELF-ADHERING DRYWALL MESH TAPE
 REFER TO TB-110 FOR INCLEMENT WEATHER

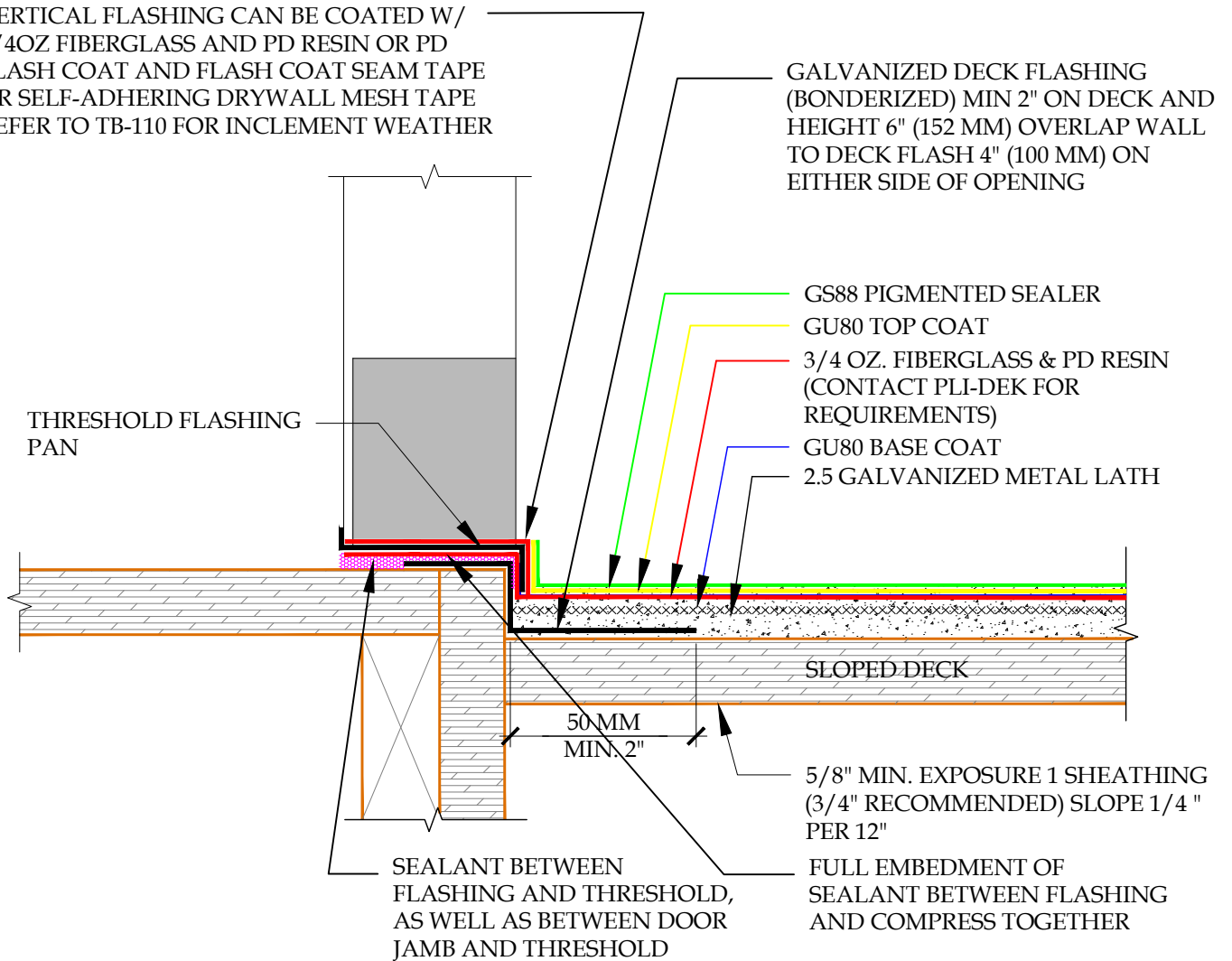

DETAIL-THRESHOLD FLASHING-TWO PIECE DOOR PAN FLASHING

SCALE: N.T.S.



These waterproofing procedures are not to be used for permit and should be reviewed by the project architect. The waterproofing procedures are not complete plans or specifications and a professional design professional should be contacted prior to performing major waterproofing and repairs.

System:		Pli-Dek System ICC-ES ESR-2097	
Detail:		THRESHOLD FLASHING- TWO PIECE DOOR PAN FLASHING	
Job:		Drawing Number:	
Date:	11/01/2020	PD-5	
Dwn:	E.L.		