

MIN. 26 GAUGE
GALVANIZED, THRESHOLD
FLASHING PER TB-110

EMBED THRESHOLD IN A
BED OF POLYURETHANE
SEALANT THAT MEETS
ASTM C-920

VERTICAL FLASHING SHALL BE COATED
WITH 3/4 OZ FIBERGLASS AND PD RESIN
OR PD FLASH COAT AND FLASH COAT
SEAM TAPE OR SELF-ADHERING MESH TAPE

GS88 PIGMENTED SEALER

GU80 TOP COAT

3/4 OZ. FIBERGLASS &
PD RESIN (2 COATS)

PRIMER AS SPECIFIED
BY TB-111

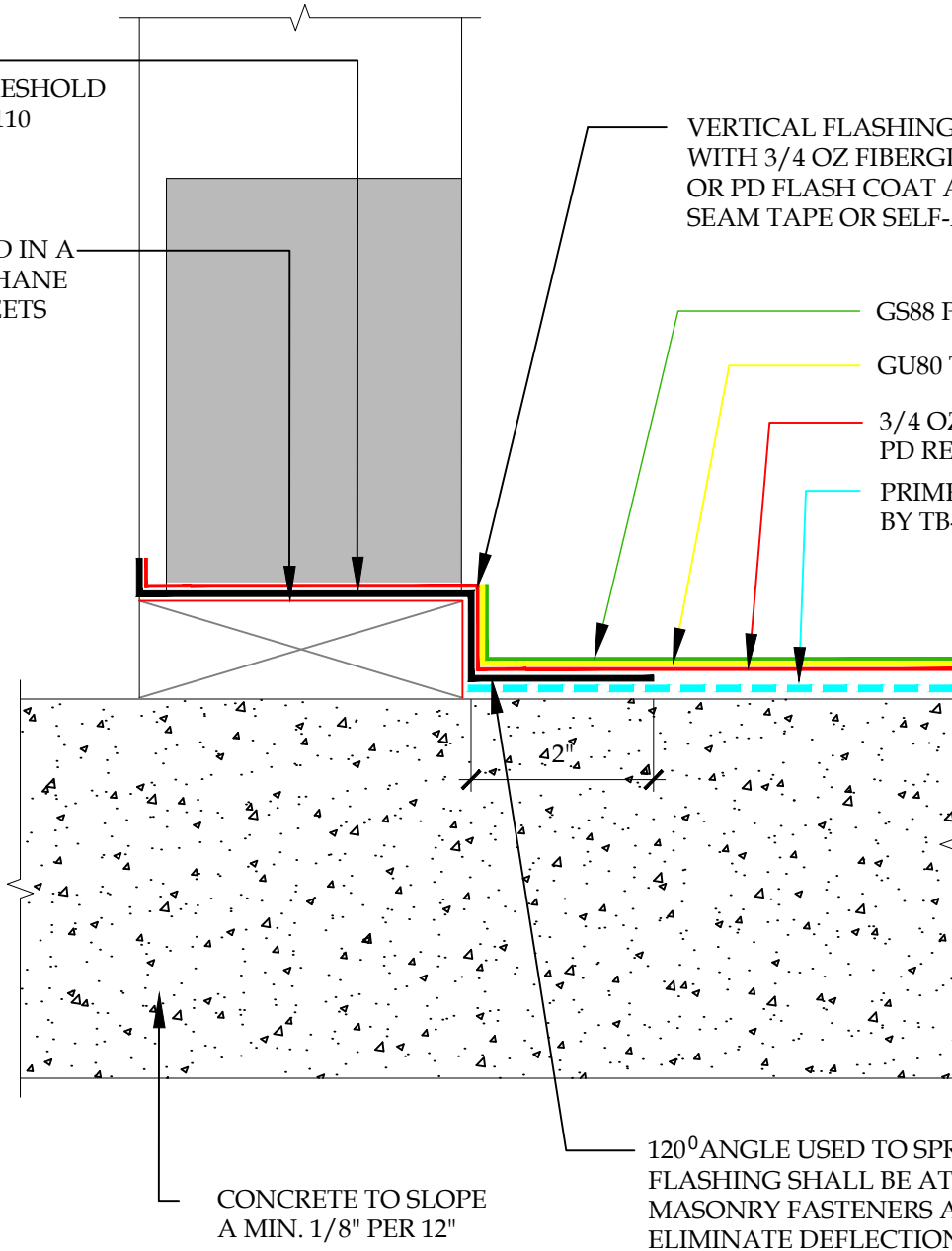

CONCRETE TO SLOPE
A MIN. 1/8" PER 12"

120° ANGLE USED TO SPRING-LOAD.
FLASHING SHALL BE ATTACHED WITH
MASONRY FASTENERS AS NEEDED TO
ELIMINATE DEFLECTION.

**DETAIL-DOOR PAN FLASHING-ONE PIECE
OVER CONCRETE SUBSTRATE - INCLEMENT WEATHER**
SCALE: N.T.S.



PLI DEK
WATERPROOFING SOLUTIONS
41610 Date St., Suite 104 * Murrieta, CA. 92562
Phone: 800.364.0287 * Fax: 951.834.9555
WWW.PLIDEK.COM

These waterproofing procedures are not to be used for permit and should be reviewed by the project architect. The waterproofing procedures are not complete plans or specifications and a professional design professional should be contacted prior to performing major waterproofing and repairs.

System:	Con-Dek System by Pli-Dek Systems, Inc. ICC-ES ESR-2097	
Detail:	DOOR PAN FLASHING ONE PIECE OVER CONCRETE SUBSTRATE INCLEMENT WEATHER	
Job:		Drawing Number:
Date:	04/01/2019	CD-2A-IW
Dwn:	E.L.	